

➤ Introduction

We, SC MOVE ECO SRL, pay special attention to communicating with our clients, in order to understand and satisfy them.

We offer post-sales services at excellent standards, we continue to consolidate ourselves and develop the market, producing and selling quality products!

Dear Client,

First of all, we are grateful to you for choosing to buy our products, the Move Eco brand, this way, the whole staff welcomes you and your sincere thanks!

This user manual has been developed to show you how to use the tricycle and how to maintain it. As soon as you have purchased the product, please read carefully and carefully the explanations to understand the product's performance, features, features to be addressed and product maintenance to fully enjoy the benefits of the electric vehicle. Make sure your trip is done in the best conditions In order to achieve effective protection and to make the use of your vehicle as easy as possible, when you purchase this product, please fill in all the items on the warranty certificate.

Before you start using the electric vehicle, please read the user manual carefully. Also, please use the vehicle only after you have understood all the features of the product.

DANGER: Ignoring these warnings can lead to injury to you or others. These warnings are intended to reduce the risk of injury.

WARNING: If you ignore the warnings, there is a risk of damage to the vehicle or damage to the components of the equipment.

➤ Declaration of conformity

This vehicle is primarily intended to operate outside public roads and designed to run on unpaved surfaces, being exempted from type approval by the Romanian Automobile Register, ACCORDING TO EU REGULATION NO. : 168/2013 DIN 15.01.2013 CONCERNING APPROVAL: CHAPTER 1, ARTICLE 2, PARAGRAPH 2, POINT G.

➤ General instructions for first use

Verification before use:

Before putting your tricycle into operation it is advisable to check the following components:

Tires

Check the tire pressure as instructed by the manufacturer; wear or if it does not show bumps, cracks or anything else that could endanger your safety and those around you.

Brakes

Being an extremely important safety factor, you should not be neglected at all!

The brake pedal and brake lever play must be checked if the dead play is the normal one.

It is proposed to check the braking system in open space at low speeds before putting into use in circulated areas!

Wheels

Check for wheel bolts if there are no weaknesses. It is recommended that the rear wheels be tightened at 60/80 Nm, and the front wheels 40/50 Nm.

Differential

This component operates with SAE 80W 90 differential oil. Due to the fact that it does not work at high speeds, differential oil change is not necessary. It changes in case of repairs or leaks.

Direction

Check that there are no front wheel or front wheel axle games.

Washing instructions

- Do not wash the batteries and the controller
- If you are washing with water jet, do not insist on the engine to avoid flooding it with water.
- Do not use the water jet on: board, buttons, stops, headlamps, signaling (basically on the electrical side)

➤ Instructions for safe use

It is necessary to follow the following guidelines:

- Check that the load to be carried does not exceed the maximum permissible gross weight
- Check the lighting system
- Check whether the bayonet and shutter locks are ok
- Make sure that when you climb into the tricycle, the ignition is in the OFF position (the tricycle is not on), because it is powered, it does not make noise when it is in place, it is dangerous to leave it with the ignition in the ON position (the tricycle is on) because by touching the accelerator lever accidentally, forgetting that I left the ignition in the ON position, it will go off, endangering your safety by attracting other damages.
- After you've boarded the tricycle:
 - ❖ Check the mirrors to be in the correct position
 - ❖ Switch contact to ON = (ON)
 - ❖ Take a look at the board to check if the battery current is sufficient for the desired travel
 - ❖ Deactivate the parking brake! (otherwise, increases the risk of serious damage to the engine, damage not covered by the warranty)
 - ❖ Set the gear depending on the driving conditions.

ATTENTION !!!

- Minimum mandatory age 18 years!

- Maximum allowable weight of 500 kg.

- It is REQUIRED that when you want to change gear: LOW / HIGH, the tricycle is stopped, otherwise the VARIOUS DIFFUSION may be damaged, this damage not covered by the warranty!

- The LOW gear will be used when climbing regardless of the load being transported or carrying a load of more than 100 kg + right-hand drive

- HIGH (lever in vertical position) will only be used ONLY on the right-hand drive with a load of up to 100 kg + driver.

- When parking, VERY IMPORTANT, switch the ignition to OFF (tricycle off), thus avoiding unwanted events.

NOTE !

- This Tricycle is equipped with an electronic acceleration cancellation system during braking, it is very important that when we brake, let go of the acceleration on the free (not to accelerate), otherwise, after we do not brake, it will accelerate again depending on the position of the throttle. **ATENTIE!**

- After stopping the tricycle, it is advisable to lock the parking brake to prevent the tricycle from sliding or slipping.

- Do not park the tricycle on tilted surfaces or if necessary, then it must be parked diagonally and not on the direction of descending / climbing.

Carriage of weights

- Distribution of the weight carried by the tricycle is done: 1/3 on the front and 2/3 on the back, evenly inside the bull.

- Never exceed the maximum authorized weight

- Reduce speed when transporting weights

- Keep the proper distance to brake in time

➤ The image of the whole tricycle

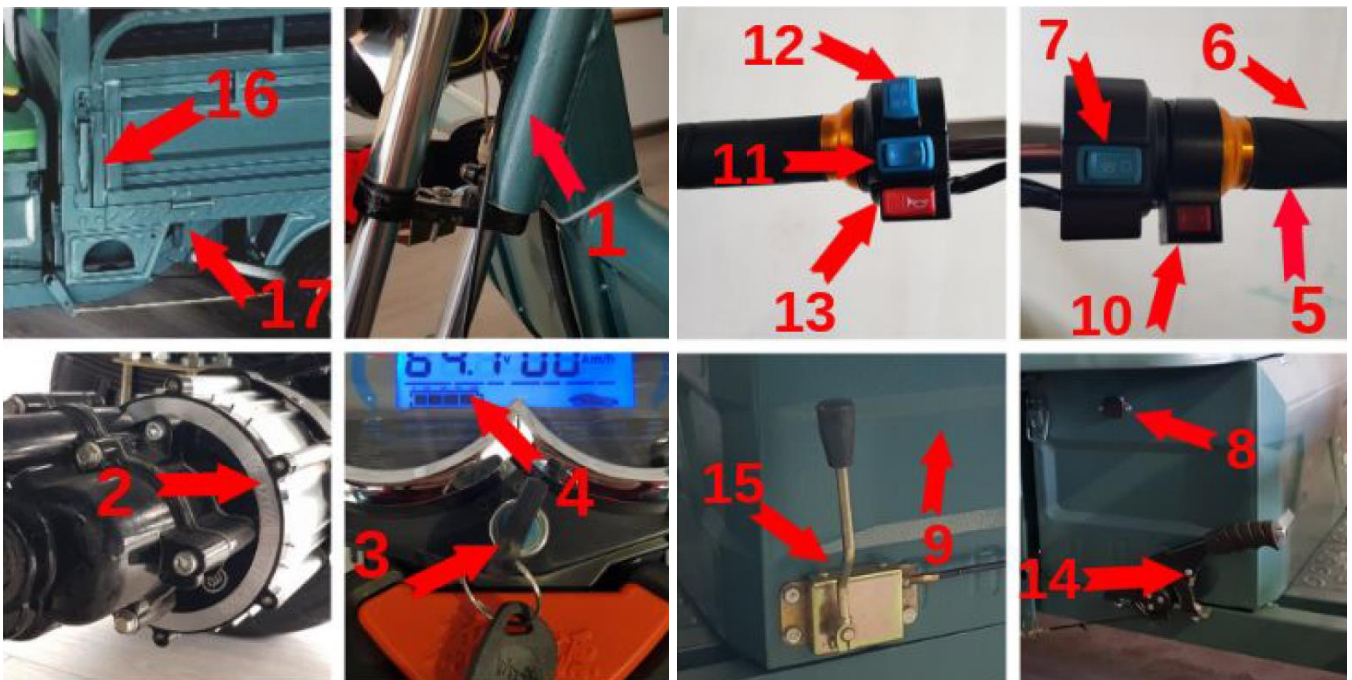

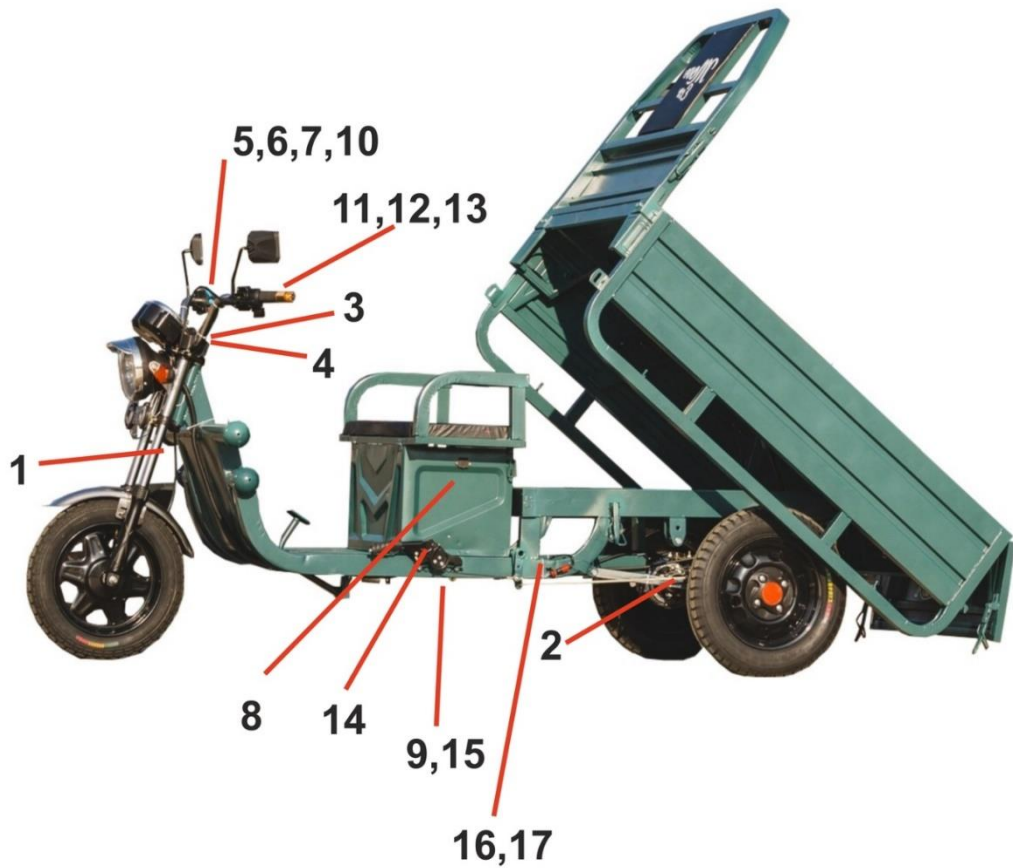

1.	Chassis series
2.	Motor number
3.	Contact key
4.	Display board
5.	Accelerator lever
6.	Front brake lever handle
7.	Front light on / off
8.	Charging plug
9.	Battery and controller place
10.	Button sense go forward / reverse
11.	Left / right signaling button
12.	Low/high beam switch
13.	Switch horn
14.	Parking brake lever
15.	Gear shift
16.	Safety shutter
17.	Safety tiller

➤ Inspection and maintenance of the tricycle

- Every time you want to get on your tricycle, check that everything is okay. The minimum checks provided in the instruction manual will be performed.
- If the tricycle is used in extreme conditions such as dust, moisture, mud, checks will be done more often.
- FOR WARRANTY MAINTENANCE always use original parts from your dealer.
- Please do not borrow it from people who are not used or trained to drive this tricycle, please do not drive with one hand, or drive after having consumed alcohol.
- Use the helmet for the head
- Wear appropriate clothing
- The storage of luggage or other objects or persons is forbidden on the foot plate, avoiding accidents.
- This vehicle uses electrical power, and when charging the battery, it is forbidden to touch the wet hands of the charger, otherwise you will be electrocuted.
- Drive at low speed on unpaved roads, with mud, snow, ice, grille to avoid injury

❖ Battery use

- The battery can be used at temperatures between -15 degrees Celsius and 45 degrees Celsius, most preferably +20 and plus / minus 10 degrees Celsius. Otherwise battery power will drop faster, and life will be shorter. In cold winter days or in low temperature geographic areas you will notice that the battery is consuming very quickly, this is normal. When the outside temperature is above 20 degrees Celsius, you will notice that the battery can recharge itself. The battery is one of the most important parts of the vehicle, so please take care to maintain it, and when the on-board checker indicates that the battery is consumed, please load it. It would be best to get used to reloading after each trip.

ATTENTION !

When purchasing the vehicle, the battery may not be fully charged, so please recharge it (the first recharge takes about 8 hours).

If you do not use the tricycle for a long time, please recharge the battery at least once a month, otherwise it will shorten the life of the battery.



Batteries should be disposed of in specially designated places for recycling!



It is forbidden to discard the trash to prevent environmental pollution!

• Checks to be made when charging the battery:

1. Check if the charger is AC 220V
2. It is advisable to keep the vehicle in frost-free places in low temperature periods in order to prolong the life of the battery if it is possible. Ex .: garage.
3. Please connect the battery first to the charger and then to the power source at a time when the vehicle can not be used.
4. When the charger LED indicates the red color, it means the battery is in the process of charging. When the red LED changes to green, it means the battery is 80% charged, this means that the battery can be used but it will be downloaded faster, so we advise you to leave it for another 1-2 hours after the red LED becomes ice green.
5. In general, charging the battery should not exceed 10 hours, if it is exceeded then its lifetime will be reduced.
6. Please connect the charger to the battery very well to avoid running. It is forbidden to store the battery in places where there is high humidity.

Cautions during charging:

- When charging the battery, be careful not to leave it in the reach of children.
- It is forbidden to use the battery before it is charged.
- Inside the battery recharging circuit there is electric current.
- When moving or stationary with the vehicle, make sure it is dry.
- While charging the battery, it is forbidden to operate it with wet hands.
- It is forbidden to break the charger parts
- Please keep the battery in an ambient environment between +10 and +30 degrees Celsius.
- Non-use for a long time, shortens the life of the battery.

Do not leave the battery in the reach of children.

- When you start charging the battery, you must have your hands dry.
- It is forbidden to store other objects over the batteries.
- Check the charger cables periodically.
- Periodically check the battery cables.

Checks to be performed by the user before going on the road:

Check the fixed parts of the braking system if they have lost or not.

- The lights system if it's OK.
- Horn if it works.
- Tire pressure and if there are impurities or tire damage.
- Control panel, check if the controls indicate correctly.
- Mirrors if adjusted and in good condition.
- Steering wheel, acceleration
- Axle of front and rear wheels.

➤ **Tehnical specifications**

Model	SYD-C06	
VIN	Frame	Motor
Speed and loadings	Max speed (km/h)	Max 25 km/h
	Average	Approx 35-50 KM battery fully charged
	Maximum loading	500 kg
	Free mass	135 kg
Battery / Motor	Battery	60V/20AH Plumb -dry
	Quantities	5 pcs
	Charging	3 Ah/h
	Charging duration	Aprox 8/10 Hour
	Motor type	DC Brushless
	Power watt	1000W
Dimensions	Front wheel	3.00/12
	Back wheel	4.00/12
	Gauge	L=2900 / l=1000 / H=1300
	Carry space	L=1450 / l=950
	Number of axis	2
	Transmision	Rear diferentiall

Others	Climb hill	≤ 25 degree
	Brake system	Drum – back/front
	Seats	1

Model	SYD-NC03	
VIN	Frame	Motor
Speed and loadings	Max speed (km/h)	Max 25 km/h
	Average	Approx 35-50 KM battery fully charged
	Maximum loading	700 kg
Battery / Motor	Free mass	135 kg
	Battery	60V/20AH Plumb -dry
	Quantities	5 pcs
	Charging	3 Ah/h
	Charging duration	Aprox 8/10 Hour
	Motor type	DC Brushless
	Power watt	1000W
Dimensions	Front wheel	3.00/12
	Back wheel	4.00/12
	Gauge	L=2900 / l=1000 / H=1300
	Carry space	L=1450 / l=950
Others	Number of axis	2
	Transmision	Rear diferentiall
	Climb hill	≤ 25 degree
	Brake system	Drum – back/front

Model	SYD-B02	
VIN	Frame	Motor
Speed and loadings	Max speed (km/h)	Max 25 km/h
	Average	Approx 35-50 KM with full battery charged
	Max loading	300
	Free mass	100kg
Battery / Motor	Battery	48V/20AH Plumb -dry
	Battery quantities	4 Pcs
	Charging	3 Ah/h
	Charging time	Aprox 8/10 ore
	Motor type	DC Brushless
	Power	800W
Dimensions	Front wheel	3.00/12
	Rear wheel	3.00/12
	Gauge	L=2350 / l=780 / H=1050
	Carrie space	L=900 / l=530
	Axis number	2
Others	Transmision	Rear differential
	Climb hill	≤ 20 degree
	Brake system	Drum- front/back
	Seats	1

➤ **Problems that may arise and identify them**

Nr crt	Malfunction	Cause of malfunction	Solve the problems
1	The speed is too low it does not work at a higher speed	<ol style="list-style-type: none"> 1. The battery is almost unloaded 2. Acceleration lever weakened 3. Acceleration Needle Failed 	<ol style="list-style-type: none"> 1. Charge the battery 2. Check if it is tight 3. Go to the vendor for change bow
2	Vehicle is not turned on when switch contact key	<ol style="list-style-type: none"> 1. The battery wire has weakened 2. Both connecting wires with left-hand levers have failed 3. The connection wire between the motor and the controller has been broken or broken 	<ol style="list-style-type: none"> 1. Repair 2. Fix 3. Go to the supplier or an accredited person to repair
3	After charging the battery, the vehicle does not run at the required speed	<ol style="list-style-type: none"> 1. Wheels do not have adequate pressure 2. The battery is not charged enough 3. The old battery has deteriorated 4. The load is too high, the wind is too strong, the brake is too tight 5. The parking brake is not fully deactivated 	<ol style="list-style-type: none"> 1. Put pressure on the tires 2. Recharge your battery check the connection thread 3. Replace the battery 4. Download the vehicle until at an appropriate weight, wait until the wind will quit, adjust the system braking 5. Disengage the brake end parking

4	Battery is not charging	<ol style="list-style-type: none"> 1. Connection wires have weakened 2. The connection socket is not in contact 3. Battery faulty 	<ol style="list-style-type: none"> 1. Repair 2. Repair or repair with spray contact 3. Replace the battery
5	It is not accelerating	<ol style="list-style-type: none"> 1. Acceleration lever faulty 2. Faulty or disrupted brake pedal sensor 3. Overheated engine 4. Contact imperfect 	<ol style="list-style-type: none"> 1. Replace the throttle lever 2. Replaced or adjusted 3. Refurbished or replaced 4. Checked and replenished with spray contact or replace sockets times cable
6	It does not leave, but the engine is spinning	<ol style="list-style-type: none"> 1. Discontinued speed changer 2. The planetary break 	<ol style="list-style-type: none"> 1. Shift gear adjustment 2. Planetary replacement
7	Another problems	<ol style="list-style-type: none"> 1. When, after removing all the malfunctions listed above, you still have not identified the malfunction 	<ol style="list-style-type: none"> 1. When you encounter such situations, please contact product provider



Warranty certificate

Dear customer

When purchasing the product, please ensure that you have received:

1. Tax documents (tax invoice / fiscal receipt, as the case may be)
2. Manual / instructions for use in English
3. Warranty certificate

Declaration of conformity:

We, SC MOVE ECO SRL, with headquarters in Oradea, str. Meșteșugarilor nr. 71, Bihor county, registered with the Trade Registry with J05 / 08/2017, C.U.I RO 36472365, legally represented by Mr. Frau Andrei, we assure, guarantee and declare on our own responsibility, according to the legal provisions regarding the regime of products and services that may endanger life, health, work safety and environmental protection, that products marketed by our company do not endanger life, health, work safety and do not have a negative impact on the environment, comply with applicable European and international regulations, respecting Directive 65/2011 / EU on the Use of Certain Hazardous Substances and Law HG 322/2013 on RoHS Compliance and are in compliance with European quality standards: EN 55022: 2010 + A C: 2011; EN 55024: 2010; EN 61000-3-2: 2014; EN 61000-3-3:

The commercial guarantee is 15 days and is granted under the conditions specified in the warranty statements and related advertising.

The compliance guarantee is granted for a period of one year, subject to the maintenance, transport, handling, storage, installation and operation instructions recommended by the seller in the accompanying product documentation. During that period, Supplier Eco S.R.L. undertakes to remove the lack of conformity by repairing, replacing or refunding the product, depending on the result of the product evaluation by the authorized service, within maximum 15 calendar days from the date of presentation of the defective product, in accordance with the legal provisions O.G. 21/1992 (r) and the Law 449/2003 (r) on the sale of products and associated guarantees. The average product use period is 1 year under the conditions of maintenance, transport, handling, storage, installation and operation. Complaints made during the warranty period by the buyer will only be taken into consideration when presenting the invoice / cash receipt and the guarantee certificate with all the completed fields and the delivered product. Authorized Service or specially delegated employees on the ground of **S.C MOVE ECO**

S.R.L., with address in Sanmartin com., Haieu village no. 29, Bihor is the only authorized and approved unit for repairing the non-conformity product, for technical revisions and any repairs. Technical inspection is performed periodically at 6 months for a cost, as it requires both a thorough check of your product (free of charge) and brake and gear change controls (if equipped), cleaning and lubrication , and other operations required to maintain your product and ensure your safety. The results of the revisions shall be completed in the guarantee certificate by the vendor's service unit. The warranty is suspended if unauthorized persons are found to intervene in the product or in circumstances that are in breach of the norms and norms in force in Romania, as well as in the case of inappropriate use and maintenance.

The rights of the consumer are not affected by the statements mentioned in this GUARANTEE CERTIFICATE, which are in accordance with the legal provisions of OG. 21/1992 (r) and Law 449/2003 (r).

In the case of warranty repairs, you are required to present the warranty certificate together with your original invoice or tax receipt to the unit where you purchased the product. The product complained of will be complete and will contain: all the necessary elements for identification, printed on the label, packaged or marked on the product. The seller shall, where appropriate, draw up a report or a service return, stating the lack of conformity, the date of referral, the submission of the indicated documents, the status of the product and the seller's point of view regarding the fulfillment of the terms of the guarantee, a document to be analyzed to meet the conditions for granting it, the product evaluation and the remedy required.

THE WARRANTY RIGHT IS LOSED FROM THE FOLLOWING GROUNDS:

- Failure to present the original invoice / invoice accompanied by the guarantee certificate with all completed fields and the product in full when requesting repair.
- Non-compliance by the purchaser with the conditions of transport, use, maintenance and installation specified in the user manual.
- The product is not fully returned, the original condition of the product has been changed, improper storage, falling / hitting, weathering, incorrect storing, faulty handling.
- If the product has defects caused by the purchaser through improper use, contrary to the recommendations in the manual
- The product has traces of bumps, bumps, accidents, overloads, acrobatics, jumping or contests.
- Interventions during the warranty period or entrust the product for

repair to other persons / service units than those authorized by SC MOVE ECO SRL.

- The malfunction occurred following a road accident as a result of incorrect installation and use.
- Do not carry out technical revisions within the specified time limits and in the units authorized by the seller.
- Failure to put the product into operation before first use results in loss of warranty.
- In the case of normal wear.
- Use of products for purposes other than those for which they were designed.
- The serial number and color of the product have been altered or deleted and no longer conform to the warranty certificate.
- Scratches and wear of wheels and other parts are normal damage and are not grounds for complaint.

OBJECT OF THE GUARANTEE:

»Front and rear hubs - change if cracks or hidden door failures do NOT change if they show marks of shaft bumps or rims.

»Wheels - change if they are cracked without showing marks of kickbacks, do not change if the use is in a decentralized state.

»Charger and batteries - changes ONLY if they show manufacturing defects, no traces of improper use or puncture, NOT changed if interfered with, or if it is found to have not been properly maintained.

»Change lever (ON THE MODELS WHICH ARE FITTED) - Changes if there are no cracks in the manufacture, NO change if there are cable or bolt failures due to incorrect handling.

»Controller - Changes if there are manufacturing defects without marks of kickbacks, **NOT changed if there are any unauthorized interventions by SC MOVE ECO SRL.**

»Engine - Change only if it has manufacturing defects.

»Handrail and handlebars - change ONLY if they show cracks due to manufacturing without any marks

»Pedal shaft - Changes if there are defects in manufacture.

»Brake - Changes if it shows marks of cracking, manufacturing defects, no kicks.

»**Tires** - will be replaced if they have manufacturing faults. DO NOT replace if there are cuts, uneven wear due to excessive braking or normal wear.

IMPORTANT! Warranty may be lost on one or more of the above components under the conditions listed above without affecting the warranty on the rest of the components.

»It is the consumer's duty to verify the product's status at the time of purchase.

»For the cables and their shirts, brake shoes, cameras, valves, headlamps, headlamps, stoppers, saddle, backrest and possible optical defects, the consumer can only request their replacement at the time of purchase.

»Centering of wheels is not warranted because de-centering occurs due to inappropriate use (jumping, obstacle crossing, turning, side skidding).

»If the axles of the front / rear wheels are bent due to improper use (eg jumping, crossing obstacles), the hubs lose their warranty. 

INSTRUCTIONS AND RECOMMENDATIONS FOR BATTERIES:

The average life of the battery is given by the storage and use mode as follows:

- Keep away from moisture, exposure to sunlight.
- Do not let it completely downloaded. It is recommended to charge even if it is not used when the charging capacity is low. Do not let it load more than necessary, but no more than specified in the Owner's Manual of the purchased product.

RECOMMENDED LOADING TIME is 6-8 hours.

- Assemble and disassemble without improvisations and observing the given instructions.

- Do not use for products other than the related product.
- Only use the battery charger provided with the product.

If you come into contact with the acid contained in the battery, battery, wash the area immediately and contact your specialist doctor without delay.

All identifiable batteries and accumulators collected in accordance with the legal provisions are treated and recycled through systems that comply with, at least, the harmonized national legislation, in particular regarding population health, safety and waste management. They are delivered to the distributors of



accumulators or specialized units providing their replacement and recycling services, not constituting household waste.

The warranty is not granted for consumables (batteries, wheels, upholstery, other plastic parts, etc.), malfunctions or damage due to accidents, improper use, negligent use, overwork, normal wear.

This warranty certificate does not cover personal injury.

The warranty applies to products that have been used correctly and are in good condition. This warranty does not cover damage caused to the product due to excessive or negligent use.

The term of guarantee runs from the date of entry of the respective good in the possession of the consumer. The downtime due to the lack of conformity within the warranty period extends the legal compliance period and the commercial guarantee term and flows, as the case may be, from the moment the seller was informed of the lack of conformity of the product or when it was presented of the product to the seller until the product is in normal use.

TEHNICAL REVIEW II

(12 months after purchase)

Product name: _____

Invoice number: _____

Service company: _____

Revision date: ____/____/____

Signature: _____



COMMISSIONING:

The following checks are performed before the first use:

- »Effective braking performance.
- »Air pressure in wheels.
- »The height of the handlebar and ensuring it can not be rotated.
 - »Correctly tighten the wheel fixing nuts.
- »Properly tighten the nuts / fastening screws, especially the suspension and the handlebar.
- »Enclosure with headlamp, beacon, stop rear.
 - »Endowment with audible warning.
- »Putting into service is free and obligatory at the time of purchase.

The buyer was informed of the proper use of the product and he checked the product delivery inventory, including the existence of the user manual and maintenance in the Romanian language. The buyer has taken note of the integrity of the product and its component parts.

We have run the test samples, received the user manual / operating instructions and presented how to use it. I accept the warranty conditions stipulated in this certificate.

Customer:

Name _____

First name _____

Adress: _____

street. _____ nr. _____ bl. _____ sc. _____

et. _____ ap. _____

Customer signature: _____



SC MOVE ECO SRL

J05/1624/2016 RO 36472365

Manufacturer, Importer, Distributor and Merchant

Office address: Oradea, str. Meșteșugarilor nr. 71, Bihor

Warehouse address: com. Sânmartin, sat Haieu nr. 29, jud. Bihor

e-mail: office@moveeco.ro

web: www.moveeco.ro

Tel: +40.742.533.608 / +40.752.856.967